



# TECMEN E4-T QUICK GUIDE



## 1. Start up

### 1. On/off:

Hold down for 3 seconds.



### 2. Airflow level:

Press the button with the fan symbol to adjust the power.



### 3. Battery:

Make sure you have enough charge before starting work.



## 2. Filters

### Gas filter:

Follow the company's procedures for replacing the filter. If you notice smell or taste during use, you must replace the filter.



### Particle filter:

The icon below shows how full the particle filter is.



God flyt



Nærmer seg tett



Tett

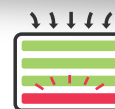

Alarm: Ingen luftflyt / Filter mangler

### Change filter:

Go to an area with fresh air. Press the orange button to remove the cover and filter. Replace with a new filter.



## 3. Charging

**Remove the battery:** Use the included hex key, or a Torx 10, to loosen the screw in the battery.

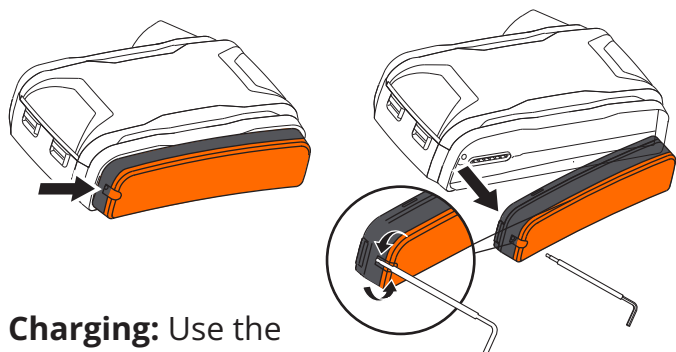

**Charging:** Use the included charging station.



## 4. After use

### Tip:

- Remove the filter from the fan unit. Follow internal guidelines for disposal or reuse. If the filter is to be used again, store it separately in a clean, airtight container to extend the filter's service life.
- Store the fan unit in a dry, clean room.
- Clean the headgear and the blower unit according to the manufacturer's recommendations.

### User guide:

To view videos, datasheets, and more, scan the QR code with your phone.



This guide is based on the manufacturer's user manual and is intended as a simplified guide. The manufacturer is responsible for accurate and complete information. For up-to-date information, please refer to the manufacturer's original user manual.