

PORTABLE
GAS DETECTION

tyco
Gas & Flame Detection

PS200 Series Portable 4 Gas Monitor



Better detection. Better protection.

The Tyco Gas & Flame Detection (GMI) PS200 Series detects all possible combinations of LEL, O₂, CO, H₂S, including single gas detection. In addition to displaying all gas readings simultaneously, the user can also initiate a manual bump test anytime.

The PS200 accessory pack includes the following as standard: USB Charging/Comms Clip, Universal Power Plug, User CD-ROM, Quick Operating Instructions. Tubing (3m) complete with a Quick Connector is also supplied as standard with pumped instruments.

Features



TECHNICAL SPECIFICATION

Size:	121 x 59 x 32mm (4.8" x 2.3" x 1.3")
Weight:	230g (8oz) with pump 215g (7.6oz) without pump
Temperature:	-20°C to +50°C (-4°F to 122°F)
Humidity:	0 to 95% R.H non-condensing
Alarms:	Highly visible flashing LED, piercing >90dB audible
Display:	Green and red LCD backlight display
Datalogging:	Timed: 24 hours of timed logs at 1 log per minute Session: Minimum of 180 logs Calibration: Minimum of 8 calibration logs Bump Logs: Minimum of 180 logs
Battery:	Lithium Ion rechargeable battery Run Time: Up to *80 / 14 hrs (diffusion) Up to *20 / 8 hrs (pumped) Charging Time < 4 hrs
Enclosure:	High impact rubberized polycarbonate case
Drop Test:	3m (10ft)
IP Rating:	IP67
Response Times (T ₉₀):	LEL = 15 secs (IEC 60079-29-1) O ₂ = 12 secs (BSEN 50104) CO < 20 secs H ₂ S < 20 secs
Approvals:	ATEX II 2G Ex ia d IIC T4 Gb IECEX Ex ia d IIC T4 Gb ATEX II 1G Ex ia IIC T4 Ga* IECEX Ex ia IIC T4 Ga* CSA Combustible Instruments: Class I, Div. 1 Groups A,B,C,D Class I, Zone 1 AEx d ia IIC T4 Gb, Ex ia d IIC T4 Gb Class I, Div. 1 Groups C,D* Class I, Zone 0 AEx ia IIB T4 Ga, Ex ia IIB T4 Ga* Non-combustible instruments: Class I, Zone 0 AEx ia IIC T4 Ga, Ex ia IIC T4 Ga MED (0038/YY) - Module B & E CE 0518
Warranty:	2 years as standard

* Low power LEL sensor

- Simple 1-button operation
- Any combination of (LEL/O₂/CO/H₂S)
- Audible, visual and vibrating alarms
- Fully certified
- Internal pump (optional)
- Run up time up to 80 hours, when using low power LEL sensor (optional)
- Lightweight
- Sensor integrity checking
- Robust construction
- Ease of maintenance
- Man down alarm (optional)



Red display in alarm conditions



Configurable calibration options



Configurable bump options

Automatic Bump Testing and Calibration

To complement the Personal Surveyor product line, Tyco Gas & Flame Detection has developed a compact, robust and easy to use Auto Bump & Calibration Station that can provide full bump and calibration options. Data transfer is facilitated using a USB memory stick with Standalone software that is simple to set up and customise based on end users' specifications. Standalone, PC, and ethernet versions are available.



Coloured 'rubber boot' for multi-site or multi-application working (7 colours available)

Standalone

By adding the Auto Bump & Calibration Station to your PS 200 package, data can be easily retrieved using specific software in a user-friendly time logged format. This gives you the ability to create and print your personalised calibration certificate.

PC

Allows easy configuration (bump test or calibration) of Auto Bump & Calibration Station and allows all results to be automatically stored to a database on the PC. The stored results can be easily viewed and calibration certificates produced. The history of all results can be easily viewed and reports of instruments can be easily compiled.

Ethernet

Same as PC except multiple units can be connected to a network allowing one PC to control and receive data.

AUTO BUMP & CALIBRATION STATION TECHNICAL SPECIFICATION

Size:	200 x 140 x 135mm (7.9" x 5.5" x 5.3")
Weight:	1.2kg (43oz)
Interfaces:	Standalone /USB /Ethernet
LED Indicators:	Power (Green) /Testing (Yellow) / Pass (Green) / Fail (Red)
Testing Time:	Bump Test 60 secs Calibration Test 90 secs
Data Storage:	>6000 Bump & Calibration results
Power Supply:	12V dc, 2A
Operating Temperature:	-10°C to 40°C (14°F to 104°F)
Gas Ports:	3 (Air, Combi Gas & Exhaust) <i>Contact GMI for other combinations</i>

SENSOR SPECIFICATION

GAS	RANGES	INCREMENTS	SENSOR TYPE
LEL	0-100% LEL	1% LEL	Catalytic Bead
O ₂	0-25%	0.1%	Electrochemical
CO	0-1000ppm	1ppm	Electrochemical
H ₂ S	0-100ppm	1ppm	Electrochemical

COMBUSTIBLE SENSOR OPTIONS

LEL SENSOR	BENEFIT	GASES DETECTED	CERTIFICATION GAS GROUPS	DIVISION / ZONE
Standard Filtered	Detects most combustible gases	C1 – C8 Hydrocarbons Includes, but not limited to: Methane, Ethane, Propane, Butane, Pentane, Hexane, Heptane, Octane, Hydrogen	IIC A,B,C and D	Class I, Div. 1,2 Zones 1,2
Enhanced Filtered	Enhanced H ₂ S and Silicone poisoning resistance	C1 – C6 Hydrocarbons Includes, but not limited to: Methane, Ethane, Propane, Butane, Pentane, Hexane, Hydrogen	IIC A,B,C and D	Class I, Div. 1,2 Zones 1,2
Low Power	Improved battery life	C1 – C5 Hydrocarbons Includes, but not limited to: Methane, Ethane, Propane, Butane, Pentane	IIB C and D	Class I, Div. 1,2 Zones 0,1,2

Simple User Maintenance

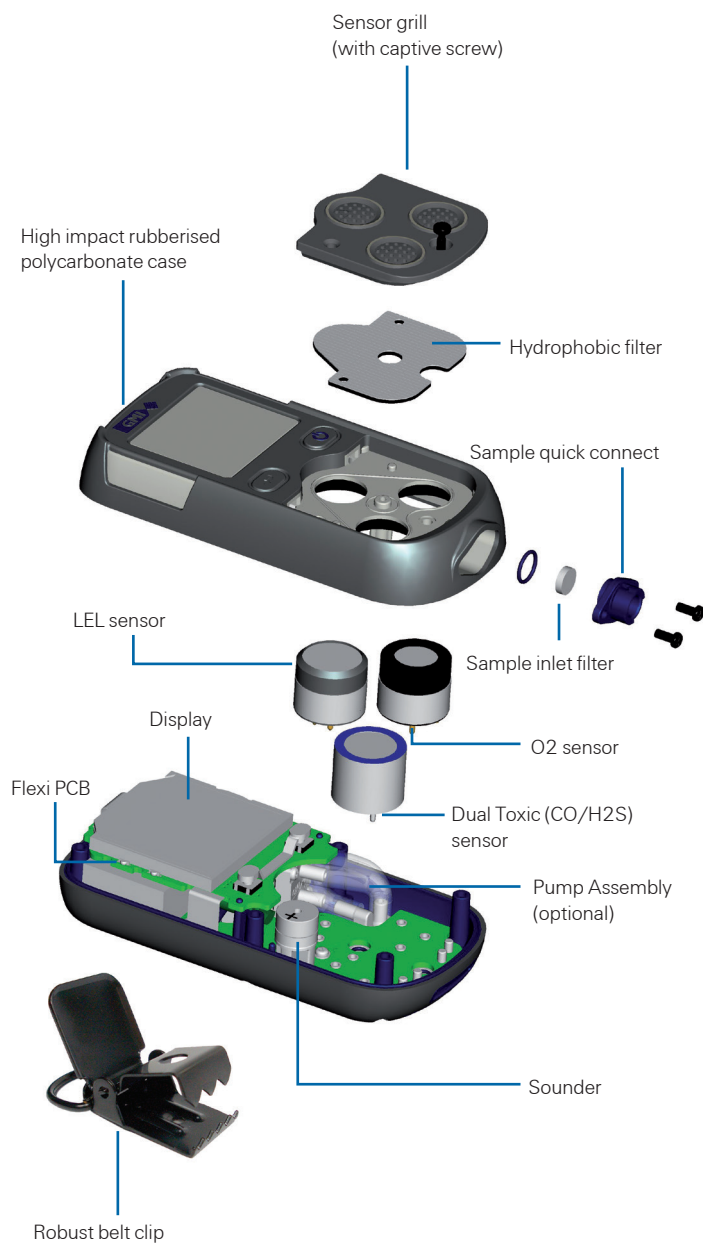

ORDERING INFORMATION AND ACCESSORIES

Accessories supplied with the instrument	
64260	USB Charging / Comms Clip
64247	Universal Power Plug (Mains – USB)
64190	User CD-ROM (Incl. Handbook)
64172	Quick Operating Instructions
64136	3m. Tubing with Quick Connector

RECOMMENDED SPARE PARTS

64254	Hydrophobic Filter
64084	Sample Inlet Filter
64825	LEL sensor (c/w Enhanced Filter)
66725	LEL sensor
66750	LEL sensor (Low Power)
64066	O ₂ sensor
64067	Dual Toxic CO/H ₂ S Sensor
64176	CO sensor
64128	H ₂ S sensor

ADDITIONAL ACCESSORIES

64303	Rubber Boot (Colour options:- black, grey, yellow, red, orange, blue, green)
66123	Hand Aspirator
66478	Hand Aspirator (c/w 10 ft. tubing)
66112	Sample Line Extender
66485	In-Line Hydrophobic Filter Assy
66545	Ball Float
64100	Rugged Carry Case
Charging Accessories	
64248	In-Vehicle Charging Adaptor (12V/24V – USB)
64138	5 Way Multi-Charger
64491	In-Vehicle Charging Cradle
Automatic Bump & Calibration	
64052	Auto Bump & Calibration Station (6mm. fittings & incl. PSU and USB stick with Standalone software)
64052Q	Auto Bump & Calibration Station (1/4 in. fittings & incl. PSU and USB stick with Standalone software)
99553	flexiCal Plus software for PC
99118	Demand Flow Regulator
64265	Tubing with 6mm Push Fit Connector
Manual Bump & Field Calibration Kit	
64051	Manual Bump Kit (no power required) (c/w Combi Test Gas 99146, Direct Flow Regulator, tubing & sample line connector)
Gas Kits for Auto Bump & Calibration Station	
99146	Combi Test Gas Cylinder (2.5% CH ₄ , 500ppm CO, 50ppm H ₂ S, 18% O ₂ , balance N ₂)
64060	Test Gas Kit (6mm fittings) (Combi Test Gas 99146, Demand Flow Regulator 99118 c/w 6mm tubing)
64060Q	Test Gas Kit (1/4 in Fittings) (Combi Test Gas 99146, Demand Flow Regulator part no. 99118 c/w 1/4" tubing)
Software	
64197	Data downloading CD-ROM (c/w Handbook)
64184	Auto Bump & Calibration Station USB Flash Drive (c/w Handbook)
Documentation	
64193	Configuration & Field Calibration Handbook (CD-ROM)

As an ISO 9001 approved company, Gas Measurement Instruments quality assurance programmes demand the continuous assessment and improvement of all GMI products. Information in this leaflet could thus change without notification and does not constitute a product specification. Please contact GMI or their representative if you require more details.

GMI -UK

Tel : +44 (0)141 812 3211
 Fax : +44 (0)141 812 7820
 sales@gmiuk.com

Service & Calibration Centre - UK

Tel : +44 (0)1908 568 867
 Fax : +44 (0)1908 261 056
 service@gmiuk.com

Sales Office - USA

Tel : 713-559-9290
 Fax : 281-292-2860
 sales@detcon.com

Service - Americas

Tel : +1 713 559 9230
 Fax : +1 281 292 2860
 detcon-service@tyco.com

